

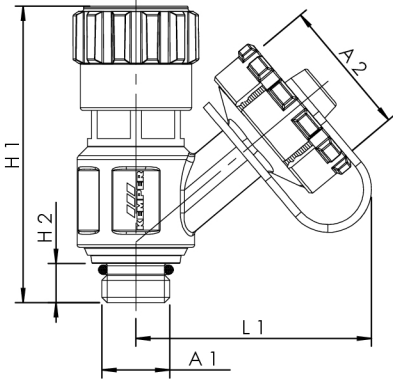

Product Features

- can be attached to all Kemper valves with test/drain-port
- rotatable hose connection element G 3/4 with cap and hanger
- wetted parts made of stainless steel
- rotating and plug-in cap
- EPDM-seat gasket
- according to accepted materials list from German environmental agency
- ÜA-Reg.-Nr. R-15.2.3-21-17049, WIEN-ZERT
- max. operating temperature 110 °C



part no.	DN	for DN	for DN with flange valves	A1	A2	H1 (mm)	H2 (mm)	L1 (mm)	kg
J71200730000600	8	15-50	15-25	G 1/4	G 3/4	53	7	37	0,088