



Product Features

- wetted metal parts made from dezincification-free and corrosion-resistant gunmetal, resistant against aggressive water
- housing with G 2 coaxial thread for meter cartridges
- consisting of flush-mounted valve and water meter housing with plaster work protectors
- for installation of a cold or hot-water metering cartridge
- installation depth variable within the installation dimensions of the water meter
- maintenance-free EPDM spindle seal
- plastic shaft can be shortened
- female pipe thread
- free from dead spots
- with casted lug for installation with optional base plate

Standards and Approvals

- flush-mounted UP valve(s) DVGW approval
- plastic parts with KTW and W 270 approval
- according to accepted materials list from German environmental agency
- flush-mounted valve with soundproofing certificate according to DIN EN ISO 3822 Class 1
- DIN EN 1213
- ÜA-Reg.-Nr. R-15.2.3-21-17048, WIEN-ZERT

Technical Data

- inside micrometer 130 mm
- pressure rating PN 10
- max. operating temperature 70 °C
- short-term peak temperature 95 °C

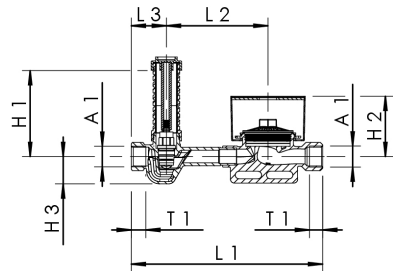

part no.	DN	A1	H1 (mm)	H2 (mm)	H3 (mm)	L1 (mm)	L2 (mm)	L3 (mm)	T1 (mm)	cv (m³/h)	kg
8552722000	20	Rp 3/4	110	76	35	245	130	45	16,3	3,72	1,332

accessory

- insulation shell for stop valve water meter combinations CLASSIC, figure 471 16
- handle for flush-mounted valves, figure 590 00
- operating cover for flush-mounted valves, figure 591 00
- fixing set UP-PLUS, figure 597 00
- UP-PLUS extension set, figure 599 00
- base plate for stop valve water meter combination CLASSIC for figur 855 27 and figur 885 27, figure 855 00 001
- cap for stop valve water meter combinations and mounting blocks, figure 855 00 002