

Product Features

- wetted metal parts made from dezincification-free and corrosion-resistant gunmetal, resistant against aggressive water
- housing with G 2 coaxial thread for meter cartridges
- consisting of two flush-mounted valves and water meter housings with plaster work protectors
- installation depth variable within the installation dimensions of the water meter
- divisible into two RG120 MONO blocks
- for installation of a cold and hot water
- of two one-piece cast water meter sections
- maintenance-free EPDM spindle seal
- female pipe thread
- free from dead spots
- with fold out mounting lugs
- mounting block foamed in pressure and tensile PU hard foam

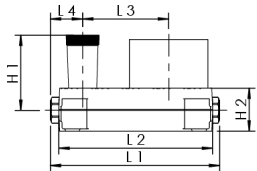

Standards and Approvals

- flush-mounted UP valve(s) DVGW approval
- plastic parts with KTW and W 270 approval
- according to accepted materials list from German environmental agency
- flush-mounted valve with soundproofing certificate according to DIN EN ISO 3822 Class 1
- to meet the requirements of EnEV 2014
- building material class B2 according to DIN 4102
- CE marking
- ÜA-Reg.-Nr. R-15.2.3-21-17048, WIEN-ZERT

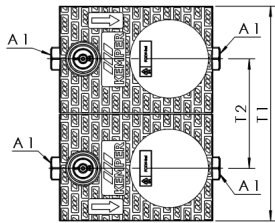

Technical Data

- inside micrometer 120 mm
- pressure rating PN 10
- max. operating temperature 70 °C
- short-term peak temperature 95 °C

part no.	DN	A1	H1 (mm)	H2 (mm)	L1 (mm)	L2 (mm)	L3 (mm)	L4 (mm)	T1 (mm)	T2 (mm)	cv (m³/h)	kg
8540702000	20	Rp 3/4	105	60	236	214	120	45	300	153	4,1	3,040

accessory

- RG120 grip top die-cast zinc set-up dimensions to 32 mm, figure 596 11
- RG120 grip top die-cast zinc set-up dimensions 30 mm to 110 mm, figure 596 12
- RG120 grip top plastic set-up dimensions up to 32 mm, figure 596 16
- RG120 grip-top plastic, set-up dimensions 30 mm to 110 mm, figure 596 17
- RG120 change stopper including extension for set-up dimensions to 110 mm, figure 596 15
- cap for stop valve water meter combinations and mounting blocks, figure 855 00 002