

Product Features

- electrical shut-off device, can be combined with flushing system
- low pressure loss
- wetted metal parts made of stainless steel and gunmetal
- two position actuator with limit sensor and actuator cut-off
- 90° rotatable
- water hammer free operation
- easy maintenance while installed
- maintenance free gear
- for integration in existing KHS mini control system
- self-centering shaft adapter with flange for assembly on the valve
- male union thread
- removable inner top part TOP-ENTRY, with EPDM gasket body and stainless steel ball
- free from dead spots

Standards and Approvals

- DVGW approval
- according to DVGW worksheet W 570
- according to accepted materials list from German environmental agency
- soundproofing certification according to DIN EN ISO 3822 Class 1
- DIN EN 13828
- ÜA-Reg.-Nr. R-15.2.3-21-17048, WIEN-ZERT

Technical Data

- pressure rating PN 16
- max. operating temperature 75 °C
- max. ambient temperature 55 °C
- protection class IP54
- power supply 230 V AC
- elapsed time for actuated changeover 35 s
- length of connection cable 1.2 m
- wire cross section 3 x 0.75 mm²

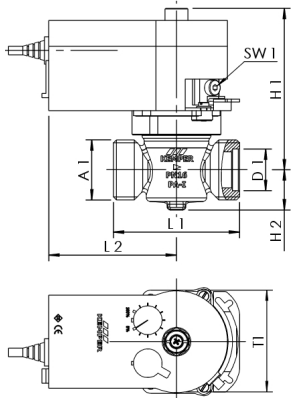

| part no. | DN | A1 | D1 (mm) | H1 (mm) | H2 (mm) | L1 (mm) | L2 (mm) | SW1 (mm) | T1 (mm) | kg |
|------------|----|---------|---------|---------|---------|---------|---------|----------|---------|-------|
| 6860401500 | 15 | G 3/4 | 18 | 110 | 25 | 73 | 89 | 4 | 72 | 1,407 |
| 6860402000 | 20 | G 1 | 22,5 | 110 | 25 | 73 | 89 | 4 | 72 | 1,14 |
| 6860402500 | 25 | G 1 1/4 | 29 | 112,5 | 28 | 88 | 89 | 4 | 72 | 1,55 |
| 6860403200 | 32 | G 1 1/2 | 35 | 115,5 | 31 | 93 | 89 | 4 | 72 | 1,72 |

accessory

- flow limiter, figure 697
- KHS free drain with overflow sensor, figure 688 00
- insulation shell for quarter turn stop valves and CONTROL-PLUS sensors, figure 471 19
- gunmetal solder union connector, figure 476 04
- gunmetal union connector, union nut, FPT, figure 476 06
- gunmetal union connector, union nut, FPT, with drain valve, figure 476 07
- gunmetal union connector, union nut, MPT, figure 476 08
- solder / pressfit union connector, figure 476 14
- pressfit union connector, MAPRESS stainless steel and copper, figure 476 22
- pressfit union connector, SANPRESS and PROFIPRESS, figure 476 30
- pressfit union connector, SANHA and NiroSan, figure 476 35
- pressfit union connector, MEPLA, figure 476 40
- pressfit union connector for Viega RAXOFIX, figure 476 32