



Product Features

- wetted metal parts made from dezincification-free and corrosion-resistant gunmetal, resistant against aggressive water
- maintenance-free EPDM spindle seal
- EPDM-seat gasket
- stainless steel cone
- plastic shaft can be shortened
- can be extended with optional extension kit
- press connection for Viega SANPRESS SST pipe and PROFIPRESS copper pipe
- free from dead spots
- with isolating, balancing and pre-setting function

Standards and Approvals

- DVGW approval
- plastic parts with KTW and W 270 approval
- according to accepted materials list from German environmental agency
- soundproofing certification according to DIN EN ISO 3822 Class 1
- DIN EN 1213
- ÜA-Reg.-Nr. R-15.2.3-21-17048, WIEN-ZERT

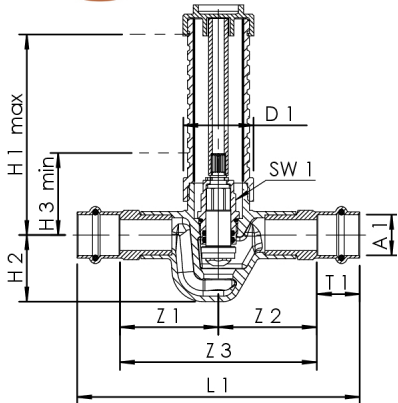

Technical Data

- max. installation depth 110 mm
- pressure rating PN 16
- max. operating temperature 100 °C

part no.	DN	A1 (mm)	D1 (mm)	H1 (mm)	H2 (mm)	H3 (mm)	L1 (mm)	SW1 (mm)	T1 (mm)	Zeta	cv (m³/h)	kg
5600601500	15	15	38,5	110	37	55	140	17	22	1,5	5,4	0,645
5600601800	15	18	38,5	110	37	55	142	17	22	2,7	5,4	0,623
5600602000	20	22	38,5	110	35	55	153	17	23,5	6,9	6	0,726
5600602500	25	28	46	115	54	55	180	17	23,5	4	12,3	1,199

accessory

- insulation shell for UP-PLUS and ETA-THERM valves, figure 471 14
- socket wrench, figure B5105 500 00 005
- handle for flush-mounted valves, figure 590 00
- operating cover for flush-mounted valves, figure 591 00
- fixing set UP-PLUS, figure 597 00
- UP-PLUS extension set, figure 599 00