



**Product Features**

- suitable for KHS CoolFlow cold water balancing valve Figs. 615 0G, 616 0G and 617 0G
- closed-cell foamed polyethylene, sound insulation
- simple installation using the insulation clips or diffusion-resistant lockable using standard adhesives

**Standards and Approvals**

- to meet the requirements of GEG 2023
- building material class B1 according to DIN 4102
- CE marking

**Technical Data**

- min. operating temperature -40 °C
- max. operating temperature 90 °C

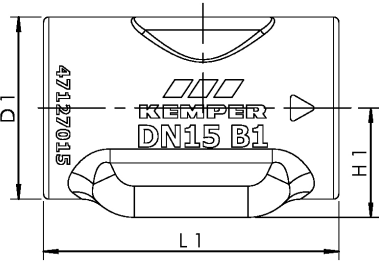

part no.	DN	D1 (mm)	H1 (mm)	L1 (mm)	kg
4712701500	15	70	42	113	0,022