

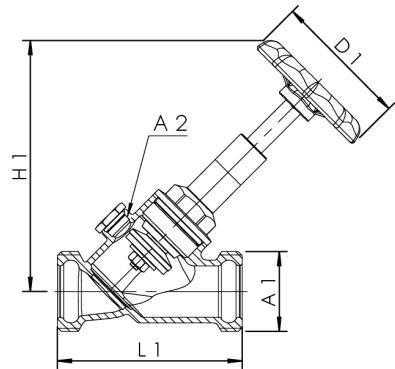

Product Features

- wetted metal parts made from dezincification-free and corrosion-resistant gunmetal, resistant against aggressive water
- spindle with O-ring
- EPDM-seat gasket
- gunmetal cone
- male union thread
- with plugged drain port
- Pt1000 temperature sensor or thermometer can be added using immersion sleeve
- with green handwheel
- free from dead spots

Standards and Approvals



- DVGW approval
- ÖVGW approval
- SVGW approval
- WRAS approval
- VA approval
- plastic parts with KTW approval
- according to accepted materials list from German environmental agency
- up to DN 32 soundproofing certification according to DIN EN ISO 3822 Class 1
- DIN EN 1213
- ÜA-Reg.-Nr. R-15.2.3-21-17048, WIEN-ZERT

Technical Data

- pressure rating PN 16
- max. operating temperature 110 °C

part no.	DN	A1	A2	D1 (mm)	H1 (mm)	L1 (mm)	Zeta	cv (m³/h)	kg
1702G01500	15	G 3/4	G 1/4	60	98	70	1,3	5,9	0,31
1702G05000	50	G 2 3/8	G 1/4	90	213	145	1,4	84,8	2,204
1702G02500	25	G 1 1/4	G 1/4	70	132	97	1,4	21,3	0,77
1702G04000	40	G 1 3/4	G 1/4	70	164	130	1,5	47,2	1,503

accessory

- gunmetal sampling valve, figure 187 00
- insulation shell for inclined stop valves, figure 471 10
- drain valve made of gunmetal/plastic, figure J7109 173 00
- axial drain valve made of gunmetal, figure J7109 170 00
- extension element for drain valve DN 8, figure J6109 473 00
- axial drain valve and immersion sleeve, figure J7109 150 00
- Pt 1000 temperature sensor, figure T5100 140 00
- dial thermometer, figure T5100 150 00
- gunmetal solder union connector, figure 476 04
- gunmetal union connector, union nut, FPT, figure 476 06
- gunmetal union connector, union nut, FPT, with drain valve, figure 476 07
- gunmetal union connector, union nut, MPT, figure 476 08
- solder / pressfit union connector, figure 476 14
- pressfit union connector, MAPRESS stainless steel and copper, figure 476 22
- pressfit union connector, SANPRESS and PROFIPRESS, figure 476 30
- pressfit union connector, SANHA and NiroSan, figure 476 35
- pressfit union connector, MEPLA, figure 476 40
- pressfit union connector, MAPRESS stainless steel, figure 476 20
- pressfit union connector, SANPRESS INOX, figure 476 70
- pressfit union connector for Viega RAXOFIX, figure 476 32