

**Product Features**

- wetted metal parts made of dezincification-free and corrosion-resistant gunmetal (in closed position), resistant against aggressive water
- for use at wet and dry fire fighting systems
- bonnet suitable for installation of a limit switch
- maintenance-free EPDM spindle seal
- EPDM-seat gasket
- cone rotatable, protected against water hammer
- inlet union nut, outlet aluminium C-coupling

**Standards and Approvals**

- DIN 14461-3 / DIN 14462 / DIN 50930-6

**Technical Data**

- pressure rating PN 16

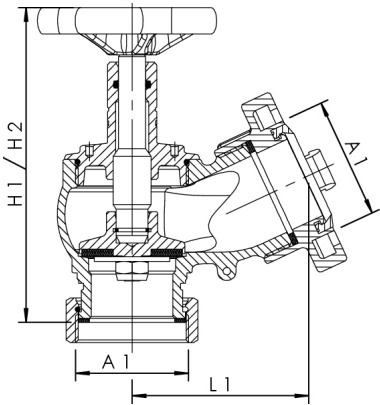

part no.	DN	A1	D1 (mm)	H1 (mm)	H2 (mm)	L1 (mm)	Zeta	cv (m³/h)	kg
1120305000	50	G 2	95	166	183	93	3,9	55	2,809