



**Product Features**

- wetted parts made of stainless steel
- maintenance-free spindle sealing with self-lubricating and under pressure replaceable EPDM-lip gasket
- EPDM-seat gasket
- cone rotatable, protected against water hammer
- press connection Geberit MAPRESS
- with sidewise drain valve, rotatable hose connection element G 3/4
- spindle thread not in contact with medium
- wear-resistant stainless steel valve seat
- with a black handwheel
- free from dead spots
- Open position indicator

**Standards and Approvals**

- DVGW approval
- SVGW approval
- KIWA approval
- VA approval
- plastic parts with KTW and W 270 approval
- according to accepted materials list from German environmental agency
- up to DN 32 soundproofing certification according to DIN EN ISO 3822 Class 1
- DIN EN 1213
- ÜA-Reg.-Nr. R-15.2.3-21-17049, WIEN-ZERT

**Technical Data**

- pressure rating PN 16
- max. operating temperature 110 °C

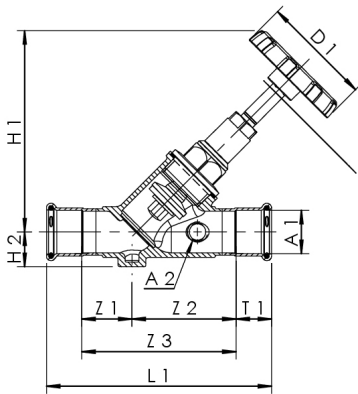

part no.	DN	A1 (mm)	A2	D1 (mm)	H1 (mm)	H2 (mm)	L1 (mm)	T1 (mm)	Zeta	cv (m³/h)	kg
0730101500	15	15	G 1/4	60	100	17,5	112	20	2,3	5,9	0,475
0730102000	20	22	G 1/4	60	100	19	125	21	1,6	12,5	0,608
0730102500	25	28	G 1/4	70	128	22,5	146	23	1,4	21,3	0,905
0730103200	32	35	G 1/4	70	145	24	167	26	1,1	38,7	1,283
0730104000	40	42	G 1/4	70	153	28	189	30	1,8	47,2	1,81
0730105000	50	54	G 1/4	90	195	33	222	35	1,4	84,8	2,894

**accessory**

- SST sampling valve, figure 087 00
- insulation shell for inclined stop valves, figure 471 10